

Groenovatie®



Aurora™ LED High Bay

PRODUCT FEATURES & BENEFITS

- System light efficacy 145~150 LPW
- Optional Plug-and-play Motion Sensor
- Rugged One-piece Die Cast Housing.
- 5 Years warranty
- IP66
- CE, RoHS
Pending - ETL, DLC Premium, CB, SAA

SPECIFICATIONS

PERFORMANCE

| | |
|-------------------|---|
| LED Chip | Philips Lumileds |
| Color Temperature | 4500~5500K (Standard) 2500~6500K (Optional) |
| Lumen Maintenance | L70>120,000 hours TM-21 Calculated |
| Input Voltage | 100-277 VAC, 220-240VAC, 277-480VAC |
| Power Factor | 0.95 minimum |
| IP Rating | IP66 |
| IK Rating | IK10 |
| Surface Treatment | Corrosive resistant polyester powder coat finish |
| Lens Material | PC 3000U |

ENVIRONMENTAL

| | |
|-----------------------|-----------------------------|
| Operating Temperature | -30°C ~ 50°C / -22°F~ 122°F |
| Storing Temperature | -40 °C~ 80°C / -40°F~ 176°F |
| Humidity | 15% to 95% RH |

PHYSICAL

| | |
|------------------|----------------|
| Fixture Material | Aluminum Alloy |
|------------------|----------------|

WARRANTY

5 Years

TYPICAL APPLICATIONS

- Warehouse/Manufacturing Facilities
- Convention Centers/Sporting Arenas
- Big-Box Retail Stores
- Cold Storage Facilities
- Gymnasiums

■ Specifications

| Picture | Part# | Power | Efficacy(IES) | Total Lumen | N.W | CRI | LED Chip | Product Dimensions |
|---|-------------|-------|---------------|-------------|---------------|-----|-----------------------|----------------------------------|
|  | EL-AUHB-100 | 100W | 150LPW | 15,000lm | 3.4kg/7.5lbs | ≥80 | Philips Lumileds 2835 | 311×311×169mm 12.2×12.2×6.7in |
|  | EL-AUHB-150 | 150W | 150LPW | 22,500lm | 3.4kg/7.5lbs | ≥80 | Philips Lumileds 2835 | 311×311×169mm 12.2×12.2×6.7in |
|  | EL-AUHB-200 | 200W | 150LPW | 30,000lm | 3.4kg/7.5lbs | ≥80 | Philips Lumileds 2835 | 311×311×169mm 12.2×12.2×6.7in |
|  | EL-AUHB-240 | 240W | 145LPW | 34,800lm | 3.4kg/7.5lbs | ≥80 | Philips Lumileds 2835 | 311×311×169mm 12.2×12.2×6.7in |
|  | EL-AUHB-300 | 300W | 150LPW | 45,000lm | 6.0kg/13.2lbs | ≥70 | Philips Lumileds 3030 | 382×382×182mm 15×15×7.2in |



■ Product Dimensions

100W~240W

300W

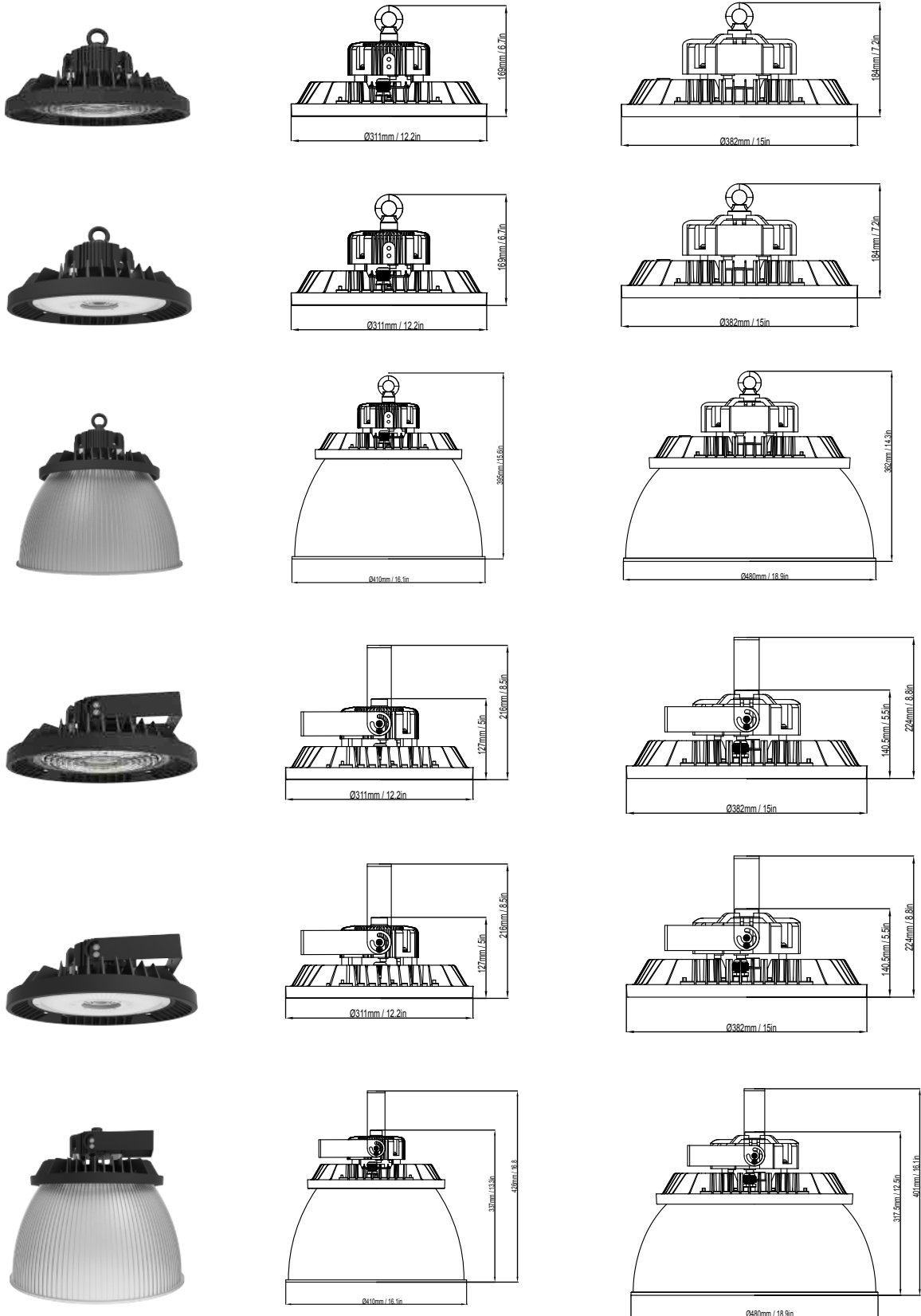

(Pending)

■ Photometrics

60° Ribbed Lens

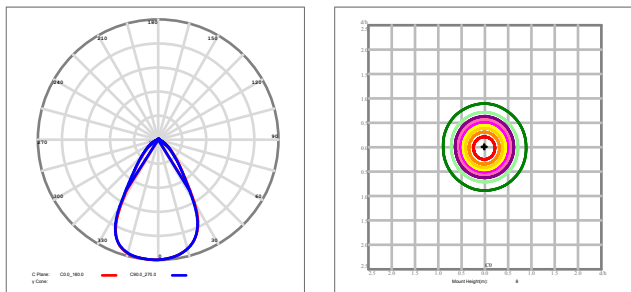

90° Ribbed Lens

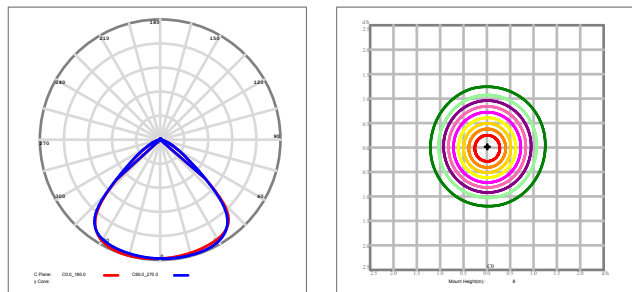

120° Diffused Dome Lens

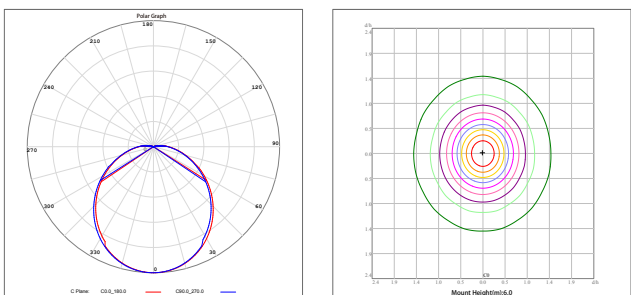

90° Reflector

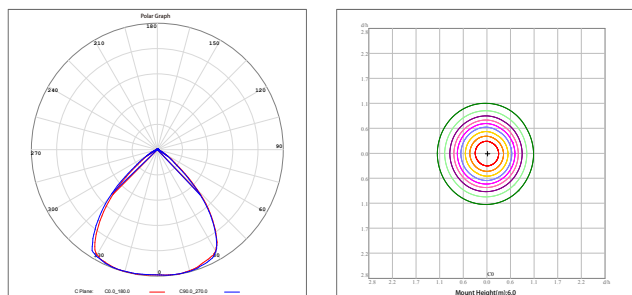

■ Dimming Control



① With sufficient ambient light, the sensor does not switch on the lamp.



② With a low light level, the sensor switches on the lamp when motion is detected.



③ After hold time, the sensor dims the lamp at a low light level if no new motion trigger.



④ After stand-by period, the sensor switches off the lamp if no motion is detected in its detection zone.

Setting

Daylight sensor: 10lux/30lux/50lux;

Setting

Detection sensitivity: 20%/50%/75%/100%;
Hold-time: 10s/1min/5min/10min/15min/20min/30min/60min;

Setting

Stand-by dimming level: 0%/10%/30%/50%;
Stand-by period: 1min/30min/60min/+∞



■ Plug-and-play Microwave Motion Sensor

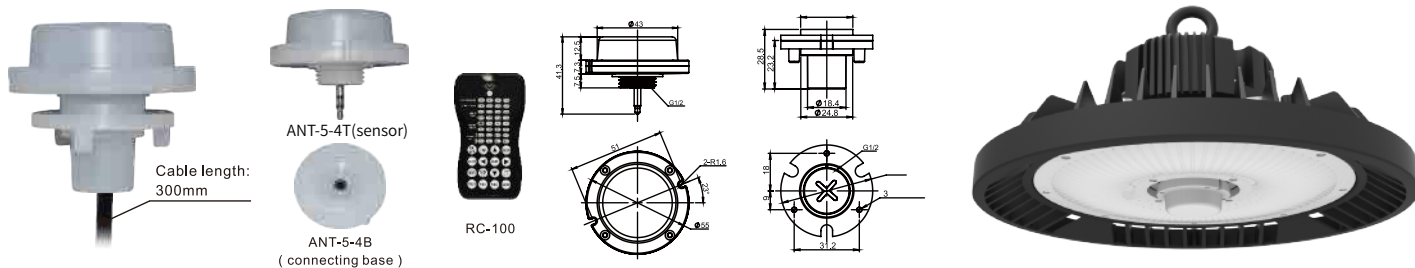

SPECIFICATIONS

| | |
|--------------------|---|
| Operating voltage | 12~24Vdc |
| Max. current sink | 50mA±5% |
| HF System | 5.8GHz±75MHz |
| Transmission power | <0.2mW |
| Dim control output | 0-10V |
| Detection radius | 20%/50%/75%/100%(1-8m) |
| Mounting height | Max 50ft.(15meters) |
| Time setting | 10s/1min/5min/10min/15min/20min/30min/60min |
| Light-control | 24H/10LUX/30LUX/50LUX |
| Temperature | -4°F ~ +140°F (-20°C ~ +60°C) |
| IP | IP65 |

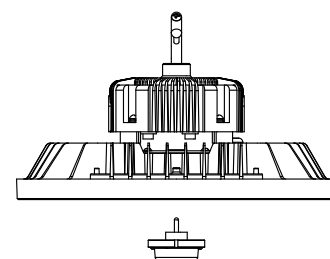

⚠ WARNING

NOTE: Warm up time is 15seconds. After the sensor connects input power first time, the light will keep on 15seconds, then go to dimming to work normally.

NOTE: Factory Default Setting: 100% sensitivity, Hold on time: 5min, Daylight sensor is ☀, Dimming level: 30%,Dimming time: 60minutes.

NOTE: Any setting changed by remote control, the led light that sensor connect will on/off as confirm.

WIRING DIAGRAMS

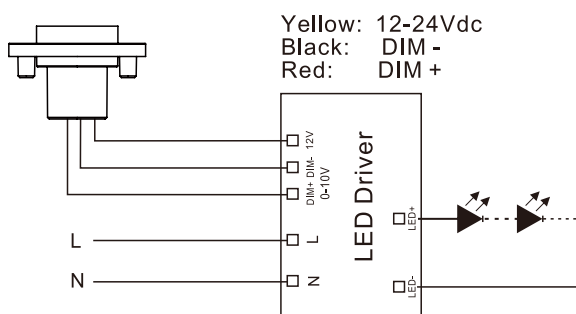

Yellow: 12-24Vdc
 Black: DIM -
 Red: DIM +

Cable specifications:
 AWM 2464 /22AWG /80°C /300V

■ Accessories

| Image | Applicable Power | Product Code | Product Description |
|---|------------------|--------------|---------------------------------------|
|  | 100W~300W | SP-SE | Plug-and-play Microwave Motion Sensor |
|  | 100W~300W | SP-HR | Hang Ring |
|  | 100W~300W | SP-HK | Hook Ring |
|  | 100W~300W | SP-UB | Standard U Bracket |
|  | 100W~300W | SP-NPT | 1/2' NPT Nipple |
|  | 100W~300W | SP-CM | Chain Mount |
|  | 100W~300W | SP-60PC | 60° Ribbed Lens (PC) |
|  | 100W~300W | SP-90PC | 90° Ribbed Lens (PC) |
|  | 100W~300W | SP-120PC | 120° Diffused Dome Lens (PC) |
|  | 100W~300W | SP-TS-90PC | 90° Reflector (PC) |
|  | 100W~300W | SP-PM | Protection Mask |

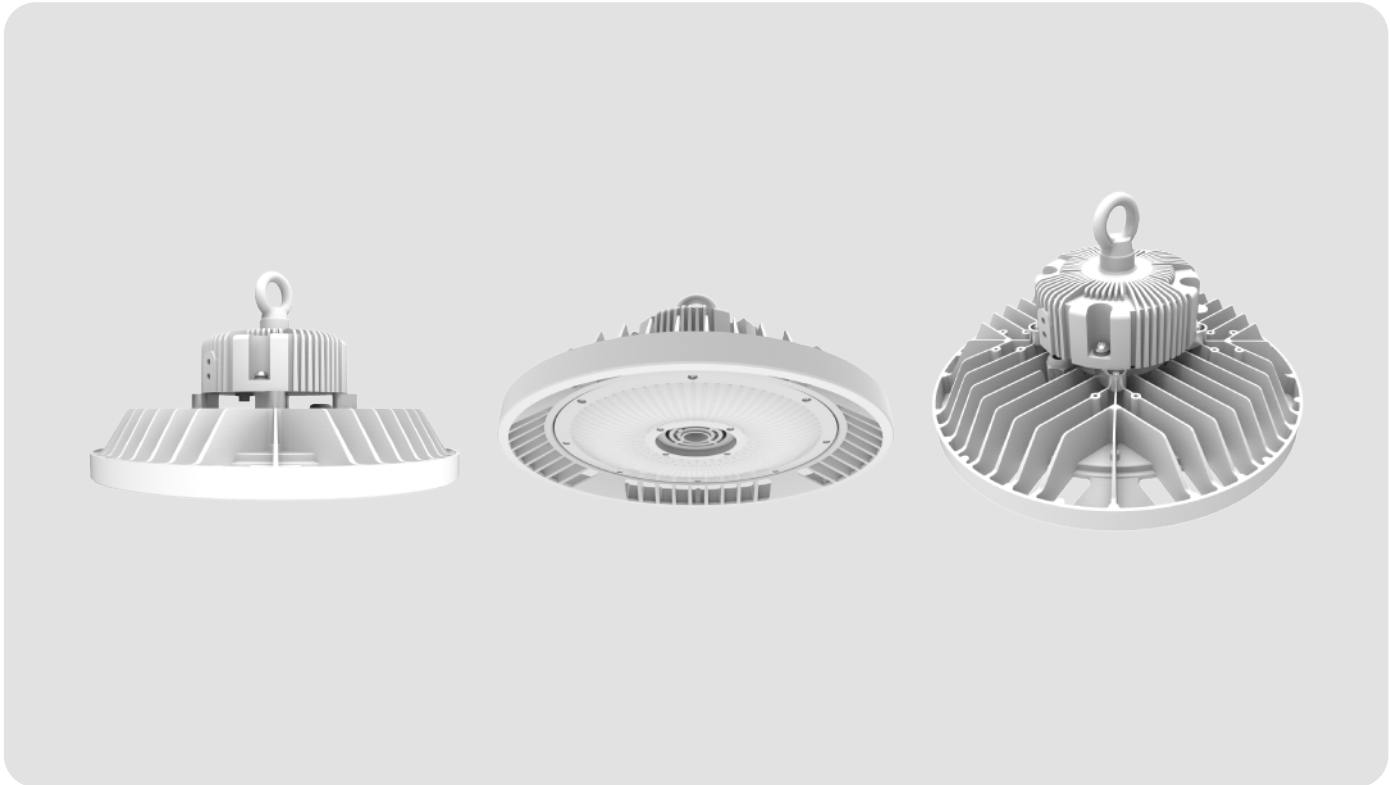

(Pending)



■ **Ordering Information** (Standard)

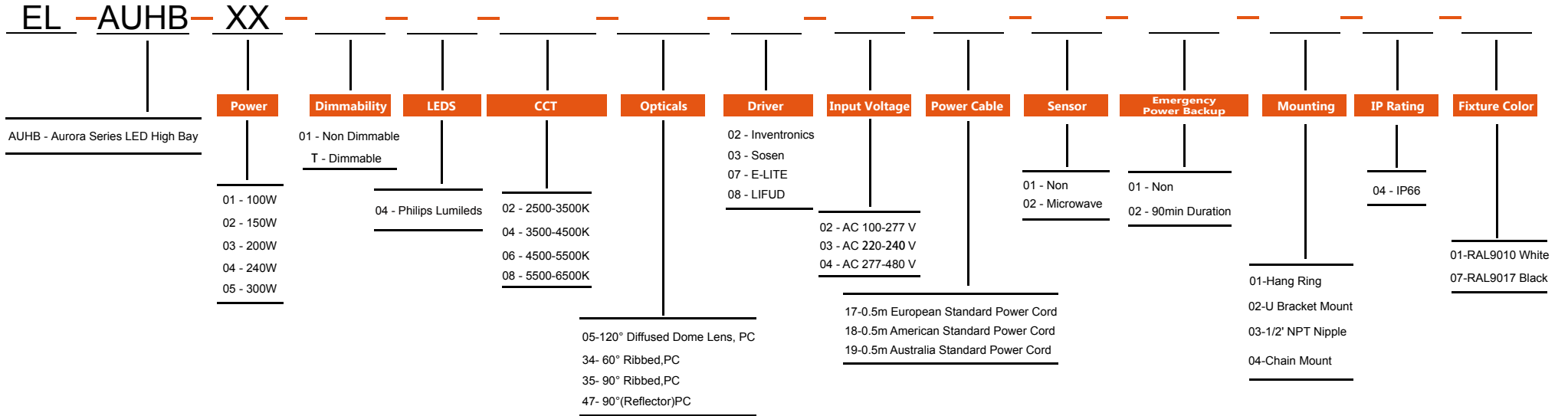

CB (Pending)