

## Rotary Knob Dimmer Switch for LED Lamps

### BRT-D205

#### I Features :

Suitable for most dimmable LED lights, such as A19, GU10, MR16 etc  
Operation Voltage: 220V~240V 50Hz  
Power Load: 150W(Max)

#### I Operation Guide :

- 1 On/Off function: Pressing the rotary button will turn on LED lamp; Pressing the rotary button again will turn off LED lamp.
- 1 Dimmer function: after turning on LED lamp, rotating the knob clockwise will increase LED lamp's brightness; rotating the knob counter-clockwise will reduce the brightness.
- 1 Minimum brightness: there are two potentiometers labeled "FINE" and "COARSE" behind the faceplate for adjusting the minimum brightness (please refer to Installation section on how to remove the faceplate assembly). After power on the dimmer switch and then rotary the main knob to the minimum brightness position. The minimum brightness can be further adjusted by tuning the "Coarse" adjustment screw using a screw driver.
- 1 Eliminate or reduce flickering: Flickering may occur for some LED lights. Following the steps blow can help to eliminate or reduce flickering:  
  
Step I. If the light is flickering, tune the "Fine" adjustment screw using a screw driver to eliminate/reduce flickering;  
Step II. If flickering persists, slightly increase the minimum brightness level by tuning the "Coarse" adjustment screw, repeat step I
- 1 One Dimmer Control or Two dimmers Control: The BRT-205 dimmer can be used to control LED lights alone or to control LED lights together with another BRT-205 dimmer. Please refer to the wiring diagram for details.

#### I Installation :

1. Disassemble the rotary knob, secondary plate and the front panel according to the diagram.

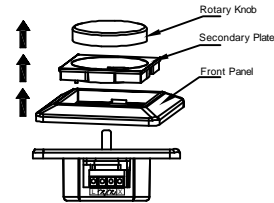

2. Jumper cap positions: The dimmer uses jumper caps to optimize dimming performance for different power loads. Please calculate the power load and set the jumper caps properly referring to the look-up table as follows:

5W-30W		
30W-60W		
60W-90W		
90W-120W		
120W-150W		

Note: The jumper caps can only be unplugged or plugged when the line voltage is not applied to the dimmer switch. Follow the look-up table closely for different power loads.

3. Connect the dimmer to power lines according to the wiring diagram.
4. Put on the rotary knob button, and press the button to turn on LED lights.
5. Rotate the knob to adjust the brightness to the minimum, and the minimum brightness can be further adjusted by the coarse potentiometer.



6. If there is flickering, please refer to Operation section on how to eliminate or reduce flickering.

7. Use screws to fix the switch into the wall box as the diagram showed.

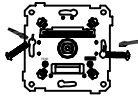

8. Assemble the rotary knob, secondary plate and the front panel according to the diagram.

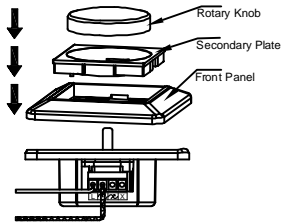

## Rotary Knob Dimmer Switch for LED Lamps

BRT-D205

### I Wiring diagram :

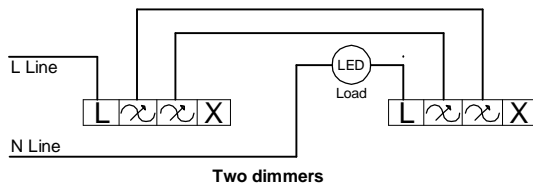
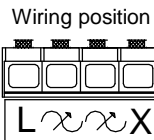
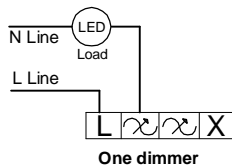

### Caution:

Installation must be done by qualified personnel only. Follow safety measures to avoid electric shock.